

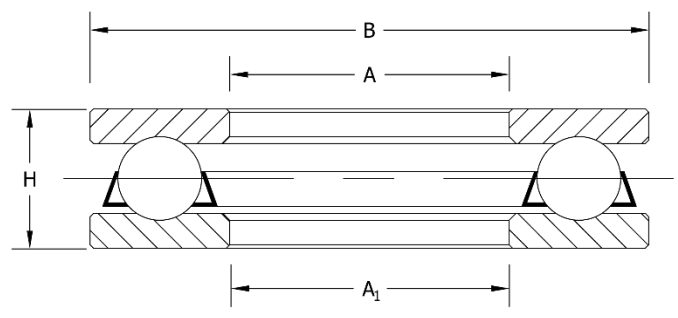

# GT Series

## Ball Thrust Bearing

Inch Dimensions  
Grooved Races  
Single Acting  
Flat Seat



BEARING NUMBER	A +.002 -.000	A <sup>1</sup> +.010 -.010	B +.000 -.003	H +.005 -.005	BALLS		LOAD RATING (lbs.)		SPEED LIMIT	BEARING WEIGHT Lbs.
					No.	SIZE	Static	Dynamic		
GT5	.753	.781	1.469	.563	14	3/16	3150	600	6400	.163
GT6	.816	.844	1.469	.563	14	3/16	3150	600	6400	.150
GT7	.878	.906	1.844	.625	12	1/4	4792	940	5400	.274
GT8	.941	.969	1.844	.625	12	1/4	4792	940	5400	.266
GT9	1.003	1.031	1.969	.625	12	1/4	4792	914	5200	.303
GT10	1.006	1.094	1.969	.625	12	1/4	4792	914	5200	.288
GT11	1.128	1.156	2.094	.625	14	1/4	5591	991	5000	.294
GT12	1.191	1.219	2.094	.625	14	1/4	5591	991	5000	.313
GT13	1.253	1.281	2.344	.625	17	1/4	6789	1085	4800	.400
GT14	1.316	1.344	2.344	.625	17	1/4	6789	1085	4800	.394
GT15	1.378	1.406	2.469	.625	17	1/4	6789	1085	4750	.431
GT16	1.441	1.469	2.469	.625	17	1/4	6789	1085	4750	.413
GT17	1.503	1.531	2.594	.625	18	1/4	7188	1087	4550	.463
GT18	1.566	1.594	2.594	.625	18	1/4	7188	1087	4550	.445
GT19	1.628	1.656	2.969	.813	16	5/16	9985	1543	3650	.825
GT20	1.691	1.719	2.969	.813	16	5/16	9985	1543	3650	.813
GT21	1.753	1.781	3.094	.813	16	5/16	9985	1543	3570	.881
GT22	1.816	1.844	3.094	.813	16	5/16	9985	1543	3570	.828
GT23	1.878	1.906	3.219	.813	20	5/16	12481	1737	3550	.945
GT24	1.941	1.969	3.219	.813	20	5/16	12481	1737	3550	.906
GT25	2.003	2.031	3.344	.813	18	3/8	16168	2349	3500	.953

<b>Northeast</b> Hauppauge, NY 1 (800) 645-5088	<b>Southeast</b> Atlanta, GA 1 (800) 247-9920	<b>Midwest</b> Chicago, IL 1 (800) 325-9696	<b>Midwest</b> Columbus, OH 1 (888) 700-9144	<b>Southwest</b> Houston, TX 1 (800) 233-5567	<b>Southwest</b> Dallas, TX 1 (800) 500-1015	<b>West Coast</b> Los Angeles, CA 1 (800) 722-0655
-------------------------------------------------------	-----------------------------------------------------	---------------------------------------------------	----------------------------------------------------	-----------------------------------------------------	----------------------------------------------------	----------------------------------------------------------



# GT Series

## GT Series – Ball Thrust Bearing - Continued

BEARING NUMBER	A	A <sup>1</sup>	B	H	BALLS		LOAD RATING (lbs.)		SPEED LIMIT	BEARING WEIGHT Lbs.
	+0.02 -0.00	+0.010 -0.010	+0.000 -0.003	+0.005 -0.005	No.	SIZE	Static	Dynamic		
GT26	2.066	2.094	3.344	.813	18	3/8	16168	2349	3500	.969
GT27	2.128	2.156	3.594	.813	18	3/8	16168	2295	3350	1.078
GT28	2.191	2.219	3.594	.813	18	3/8	16168	2295	3350	1.063
GT29	2.253	2.281	3.719	.813	18	3/8	16168	2295	3300	1.156
GT30	2.316	2.344	3.719	.813	18	3/8	16168	2295	3300	1.125
GT31	2.378	2.406	3.844	.813	18	3/8	16168	2295	3250	1.165
GT32	2.441	2.469	3.844	.813	18	3/8	16168	2295	3250	1.125
GT33	2.503	2.531	3.969	.813	22	3/8	16168	2295	3200	1.196
GT34	2.566	2.594	3.969	.813	22	3/8	19760	2601	3200	1.375
GT35	2.628	2.656	4.344	1.000	18	7/16	22016	3104	2750	1.907
GT36	2.691	2.719	4.344	1.000	19	1/2	22016	3104	2750	1.875
GT37	2.753	2.781	4.469	1.000	20	1/2	31950	4302	2700	1.875
GT38	2.816	2.844	4.469	1.000	20	1/2	31950	4302	2700	1.938
GT39	2.878	2.906	4.594	1.000	20	1/2	31950	4302	2670	2.047
GT40	2.941	2.969	4.594	1.000	20	1/2	31950	4302	2650	1.946
GT41	3.003	3.031	4.719	1.000	20	1/2	28755	3775	2630	2.078



**Materials:** Rings and balls are constructed of thru-hardened 52100 steel. Retainer is pressed steel.

**Northeast**  
Hauppauge, NY  
1 (800) 645-5088

**Southeast**  
Atlanta, GA  
1 (800) 247-9920

**Midwest**  
Chicago, IL  
1 (800) 325-9696  
Columbus, OH  
1 (888) 700-9144

**Southwest**  
Houston, TX  
1 (800) 233-5567  
Dallas, TX  
1 (800) 500-1015

**West Coast**  
Los Angeles, CA  
1 (800) 722-0655